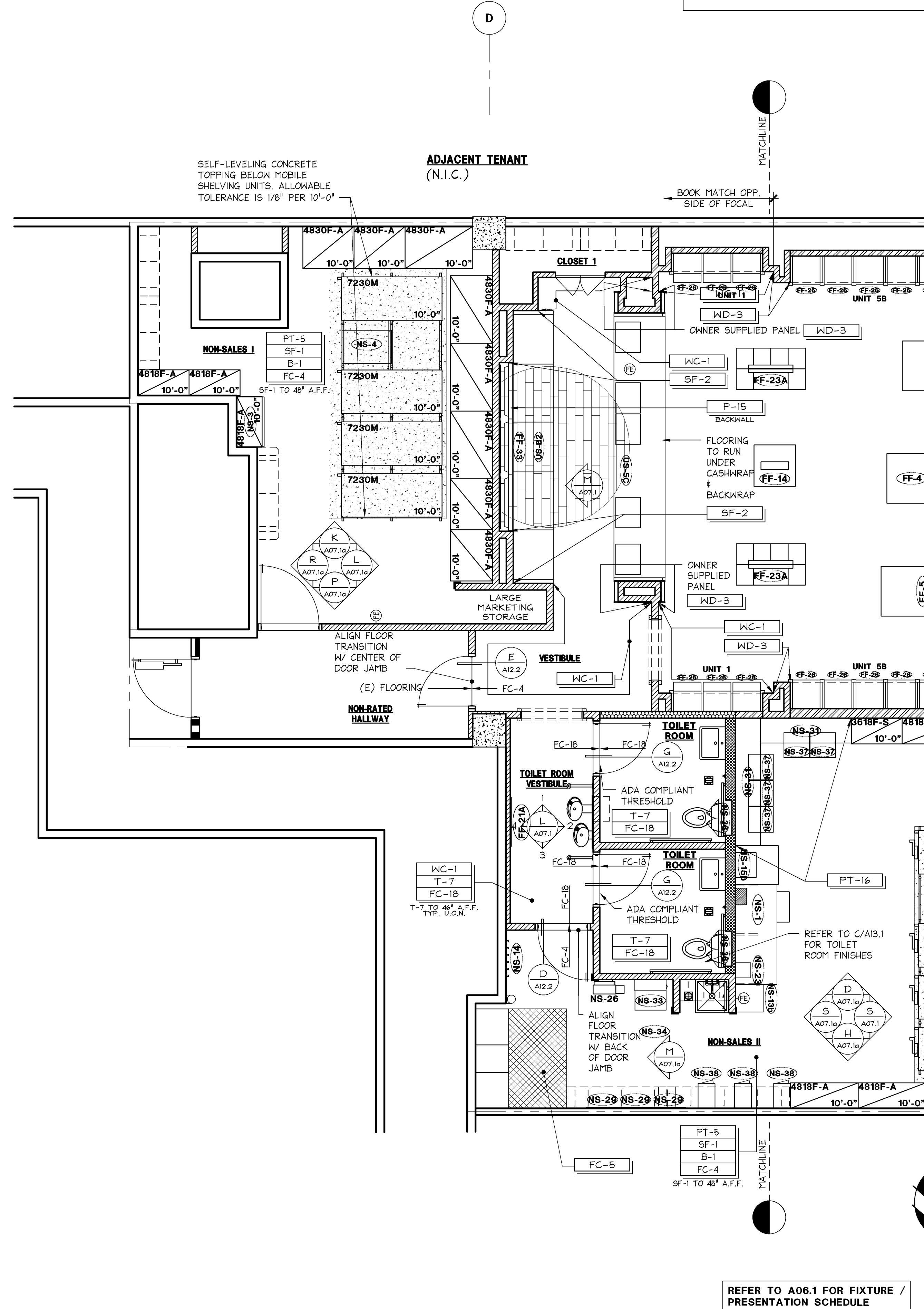
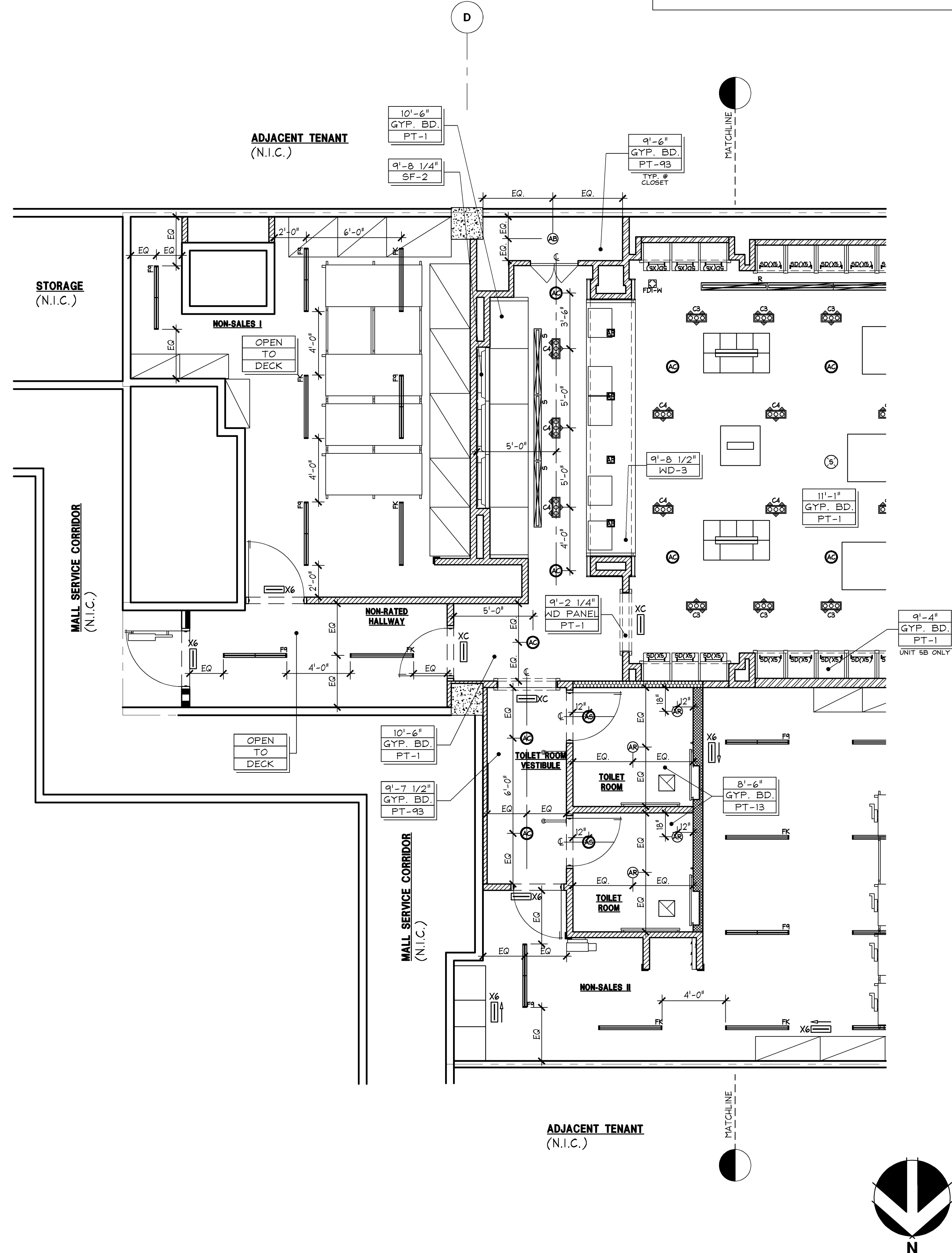

REFLECTED CEILING PLAN:

- IF NOT ALREADY EXISTING, TENANT MUST PROVIDE A SEALED PARTITION ABOVE THE STOREFRONT TO SEPARATE THE COMMON AREA CEILING FROM THE TENANT'S SPACE. (SHALL BE RATED IF REQUIRED BY CODE AND ALL PENETRATION SHALL COMPLY AND BE LABELED WITH THE REQUIRED NFPA RATING.)
- NOTHING IS PERMITTED TO BE ATTACHED TO, SUSPENDED FROM, OR PENETRATE LANDLORD'S STRUCTURE, FLOOR DECK, OR ROOF DECK. TENANTS MAY ATTACH, NONDESTRUCTIVELY, TO OR SUSPEND FROM THE TOP CHORD OF THE JOIST OR THE STRUCTURAL STEEL WHICH EXISTS ABOVE THE TENANT SPACE. WHEN ATTACHING TO LANDLORD'S STRUCTURE, DO NOT DRILL, NAIL, SCREW, OR SHOOT INTO STRUCTURE. ALTERNATIVE METHODS OF ATTACHMENT ONLY, NOTHING TO DAMAGE LANDLORD'S BASE BUILDING STRUCTURE. TENANT SHALL PROVIDE SIGNED AND SEALED STRUCTURAL DRAWINGS, BY A STRUCTURAL ENGINEER WITH LEGALLY ACTIVE REGISTRATION AS INDICATED BY ALL JURISDICTIONAL REQUIREMENTS, FOR ALL STRUCTURAL MODIFICATIONS FOR LANDLORD RECORDS.
- ANY LANDLORD EQUIPMENT, COMPONENT, AND / OR SERVICE FEEDING OTHER TENANT(S) THAT IS EXISTING IN THE SPACE MUST REMAIN VISIBLE AND ACCESSIBLE TO THE LANDLORD. TENANT SHALL INSTALL ACCESS PANELS AS REQUIRED TO MAINTAIN ACCESS. ACCESS PANELS SHALL BE LABEL TO PROPERLY IDENTIFY SYSTEM, COORDINATE WITH MALL OPERATIONS.
- SIMON PROPERTY GROUP REQUIRES ALL TENANTS TO USE LANDLORD'S REQUIRED CONTRACTOR FOR ALL SPRINKLER WORK. REFER TO SPRINKLER COMMENTS FOR FURTHER REQUIREMENTS

SPRINKLER COMMENTS:

- ALL SPRINKLER WORK (SHOP DRAWINGS) TO BE APPROVED BY LANDLORD'S INSURER. SUBMIT PLANS TO: GLOBAL RISK CONSULTANTS - SEE BELOW.
- SPRINKLER SYSTEM MUST BE FULLY CHARGED AND OPERATIONAL WHENEVER CONTRACTOR IS NOT ON SITE.
- SIMON PROPERTY GROUP REQUIRES ALL TENANTS TO USE SIMPLEX GRINNELL FOR ALL SPRINKLER WORK.
- AT TIME OF BIDDING, TENANT OR T.G.C. SHOULD CONTACT SIMPLEX GRINNELL'S NATIONAL ACCOUNTS REPRESENTATIVE TO OBTAIN DIRECTION FOR PRICING AND SCHEDULING. 800-299-4377 / OPTION #4
- TENANT OR T.G.C. IS REQUIRED TO CONTRACT WITH AND PAY FOR ALL TENANT SPRINKLER WORK DIRECTLY WITH SIMPLEX GRINNELL.
- SIMON PROPERTY GROUP REQUIRES ALL TENANTS TO USE LANDLORD'S PRE-QUALIFIED SPRINKLER CONTRACTORS FOR TENANT'S SPRINKLER WORK. TENANT MAY COMPETITIVELY BID TO ONLY THOSE SPRINKLER CONTRACTORS PRE-QUALIFIED BY LANDLORD (CONTACT THAT MALL MANAGER OR OPERATIONS DIRECTOR FOR A LIST PRE-QUALIFIED SPRINKLER CONTRACTORS).

FOR CONTINUATION OF PLAN,
SEE A05.1 & A06.1REFER TO A08.1 FOR FIXTURE /
PRESENTATION SCHEDULEFOR CONTINUATION OF PLAN,
SEE A04.1

REVISIONS:

24200161

BATH & BODY WORKS

THE GALLERIA II

SPACE INC. 15060

HOUSTON, TX 77056

SCOPE:

DESIGN TYPE:

LSDAC PROJECT #:

DATE ISSUED:

DESIGNED BY:

DRAWN BY:

CHECKED BY:

NON-SALES
PLANS
CONTINUED

DRAWING NUMBER:

A02.2a